

# *N-100 Gable Top Packaging Machine*

## ● **Fill Volume**

- 125 to 500ml (metric)
- 4 to 16 oz (US measure)

## ● **Up to 10,200 cph (170 cpm)**

- 125 to 250ml (4 to 8 oz.)

## ● **Up to 8,500 cph (142cpm)**

- 300 to 500ml (10 to 16 oz.)

## ● **Low Infeed Loading Height**

- Ergonomic design for operator safety and comfort

## ● **Pyramid Bottom**

- Smooth outer edge provides flat plane for carton to rest on shelf

## ● **Less Downtime - Infinite Fill Adjustment**

- Quick and easy changes to fill volume and carton height

## ● **Servo Driven Fill and Conveyor Chains**

- Automatically controls fill volumes and profiles based on product and carton size

## ● **Two-Station Top Down Fill System**

- Double diaphragm metering bowl enables accurate, consistent fill volumes

## ● **Two-Stage Top Sealing**

- Provides gentle and uniform heat

## ● **Simple to Operate and Maintain**

- Easy access
- Robust design reduces machine down time
- Auto lubrication system standard

## ● **Options:**

- Closure system
- ESL features
  - HEPA
  - Auto sanitize
  - Carton sanitization
    - L1 through L4 available
- Dedicated CIP
- Production indicator
- Product tank drain
- Twin product tanks
- Particulate fill system

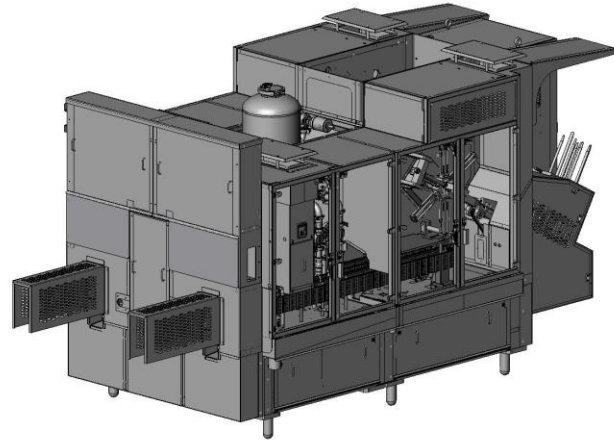

# *N-100 Gable Top Packaging Machine*

## Utility Requirements:

- **Electrical:** 3 phase, 50/60 Hz, 460 volt
  - **Cooling Water:** 10 GPM at 34° F (38 LPM at 1° C)
  - **Compressed Air:** 55 SCFM at 85 PSIG  
(1.56 M<sup>3</sup>/min at 6.0 KG/CM<sup>2</sup>)
- (Final utility requirements to be determined.)

## Dimensions:

- 420cm (13' 9") long x 222cm (7' 3") wide x 259cm (8' 6") high
- 9.3 m<sup>2</sup> (99.7 ft<sup>2</sup>)

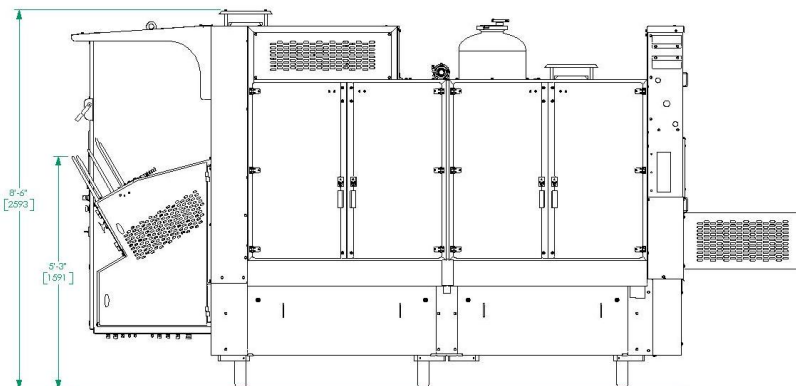
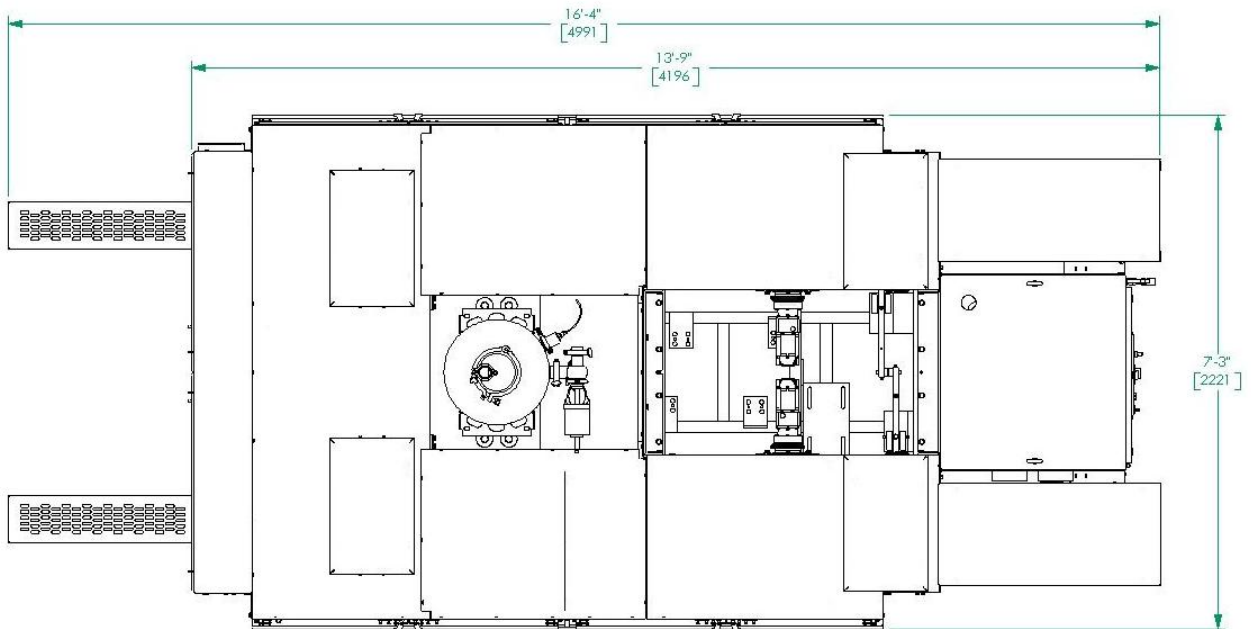

2400 Sixth Street SW  
Cedar Rapids, IA 52404 USA  
Phone: 319-399-3200  
Fax: 319-399-3543