

# Q-35 Gable Top Packaging Machine

## ● Fill Volume

- 180ml to 1.15L (metric)
- 6 to 32 oz (US measure)

## ● Up to 3,500 cph (58 cpm) – liters/quarts

## ● Up to 4,500 cph (75cpm) – fractional sizes

## ● Low Infeed Loading Height

- Ergonomic design for operator safety and comfort

## ● Less Downtime - Infinite Fill Adjustment

- 180ml to 1.15 Liter
- Quick and easy changes to fill volume and carton height

## ● Servo Driven Lift, Fill and Conveyor Chains

- Automatically controls fill volumes and profiles based on product and carton size

## ● Single Station Foam Free Bottom-Up Fill System

- Double diaphragm metering bowl enables accurate, consistent fill volumes

## ● Two-Stage Top Sealing

- Provides gentle and uniform heat

## ● Pyramid Bottom

- Smooth outer edge provides flat plane for carton to rest on shelf

## ● Operator and Maintenance Functions Separated

- Simple to operate and maintain
- Easy access
- Robust design reduces machine down time

## ● Options:

- SPOUT-PAK® system
- ESL features
  - HEPA
  - Auto sanitize
  - Carton sanitization
    - L1 through L4 available
- Dedicated CIP
- Auto lubrication
- Particulate fill
- Production indicator
- Juice nozzle
- Product tank drain



# Q-35 Gable Top Packaging Machine

## Utility Requirements:

- **Electrical:** 3 phase, 50/60 Hz, 380 volt
- **Cooling Water:** 5 GPM at 34° F (19 LPM at 1° C)
- **Compressed Air:** 32 SCFM at 85 PSIG  
(0.91 M<sup>3</sup>/min at 6.0 KG/CM<sup>2</sup>)  
(Final utility requirements to be determined.)

## Dimensions:

- 422cm (13' 10") long x 155cm (5' 1") wide x 281cm (9' 3") high
- 6.5 m<sup>2</sup> (70.3 ft<sup>2</sup>)

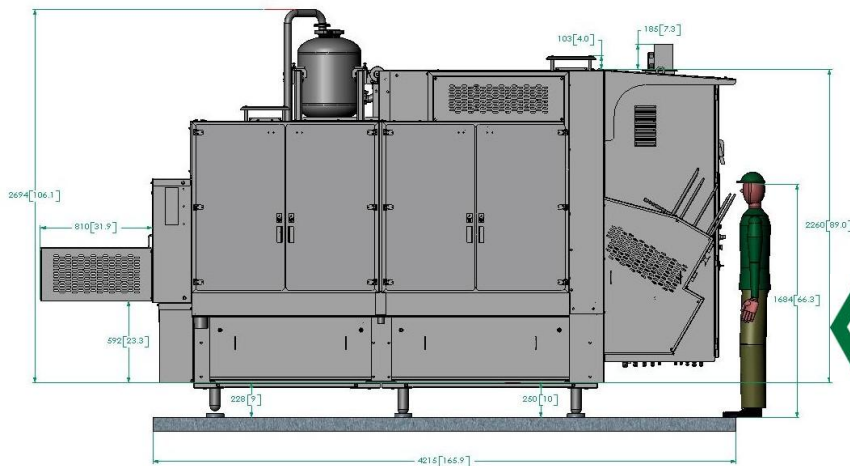
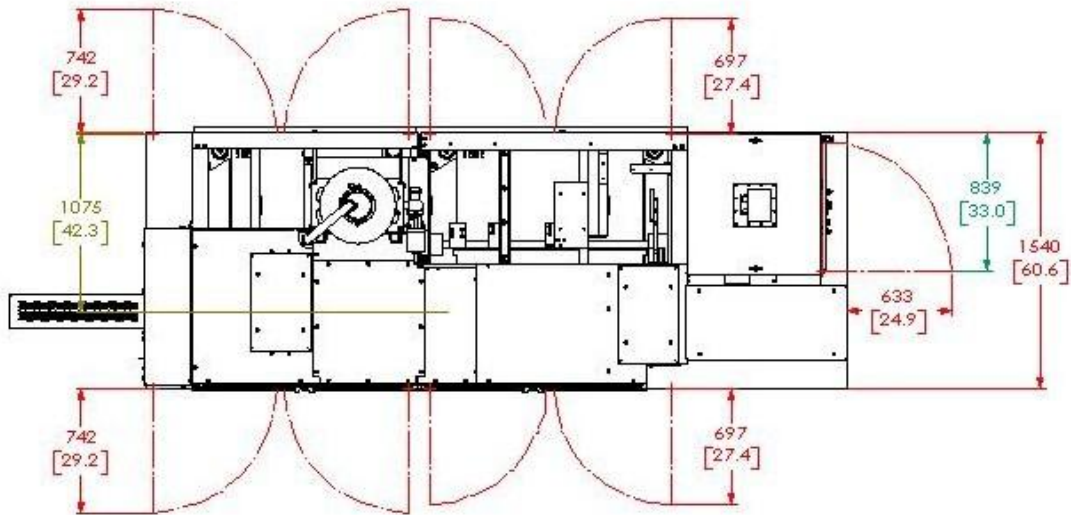

2400 Sixth Street SW  
Cedar Rapids, IA 52404 USA  
Phone: 319-399-3200  
Fax: 319-399-3543